



Garfield Super Block

A park for the people, by the people





ROBERT STEPHENS

GSB Coalition Founder

Robert Stephens Jr. was born in Shreveport, Louisiana and settled in Seattle's Central District with his family in 1959. He attended Horace Mann Elementary, Meany Junior High, and Garfield High School, obtaining his undergraduate degree from the University of Washington and Master's in Education from Western Washington University.

Robert had a profound impact on the cultural life of the Central District, helping create programs and community facilities such as Black Arts West, Langston Hughes Theater, Medgar Evers Pool, Madrona Dance Studio (Spectrum Dance Studio), and Seattle Veterans Program (SEA/VETS), just to name a few. He volunteered on the Design & Review Stewardship Team that renovated Garfield High School and built the Quincy Jones Performance Center. He also established the Central Area Cultural Arts Commission to ensure that the stories and experiences of the African-American population and other ethnic communities would not be erased by gentrification and redevelopment. Today, Robert Jr. still lives in the Central Area home his parents purchased back in January 1959.

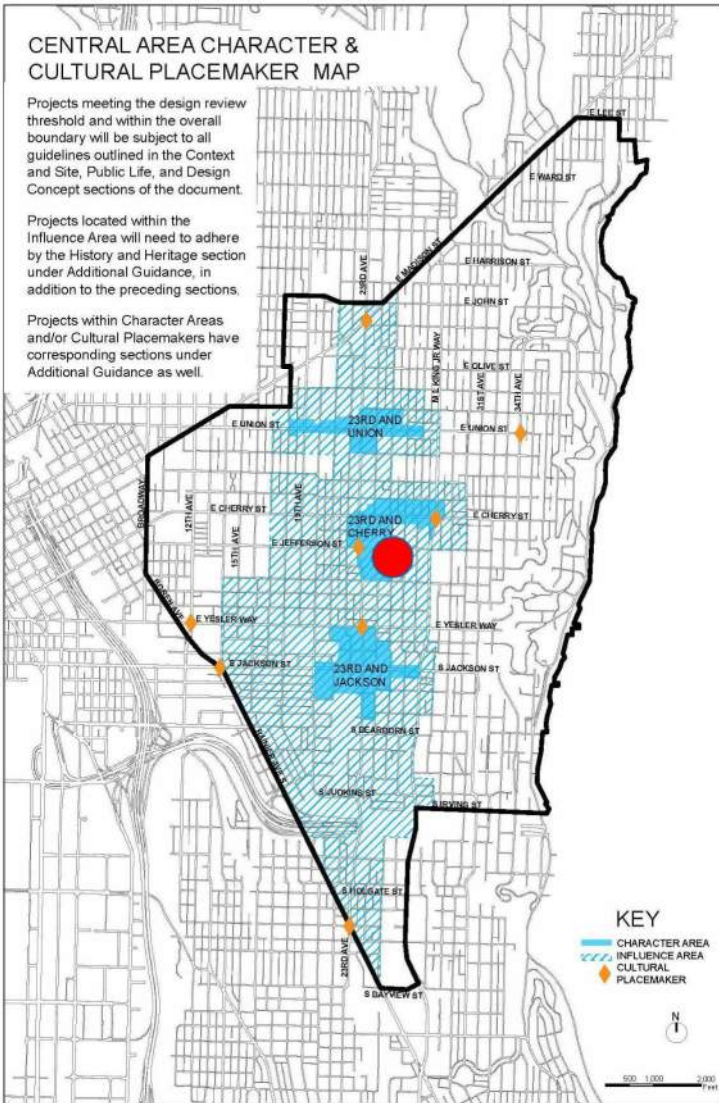

MASTERPLAN DESIGN A, 2005
Midblock Scheme



Project History:
20 years of
community
efforts

Existing Site Conditions





Major Upgrades Include:

- Loop path around the fields
- New comfort station with community concessions
- Parkour Park
- New playground + mini play opportunities
- Basketball hoops
- Accessible ramp on the SE corner
- Community public art

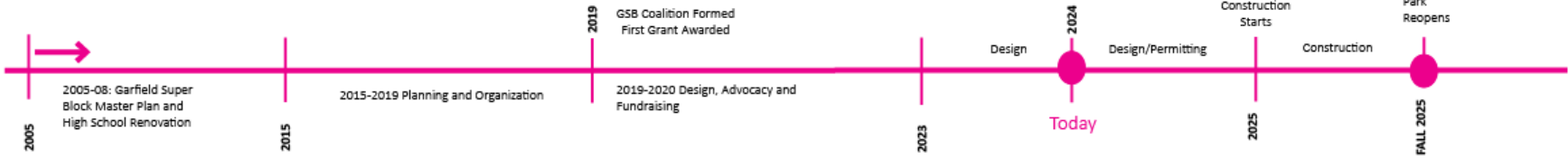

WATER FEATURE & PICNIC SHELTER

GOALS:

- Small Water feature w/ nozzle (Recirculating system)
- Pre-fabricated Picnic Shelter w/ large group table

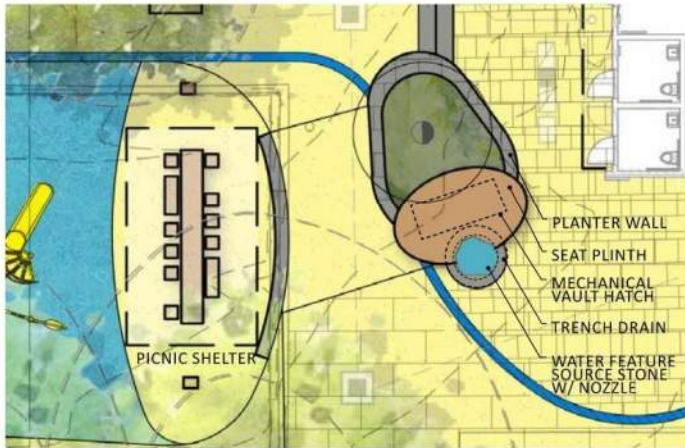

PICNIC SHELTER



GROUP TABLE

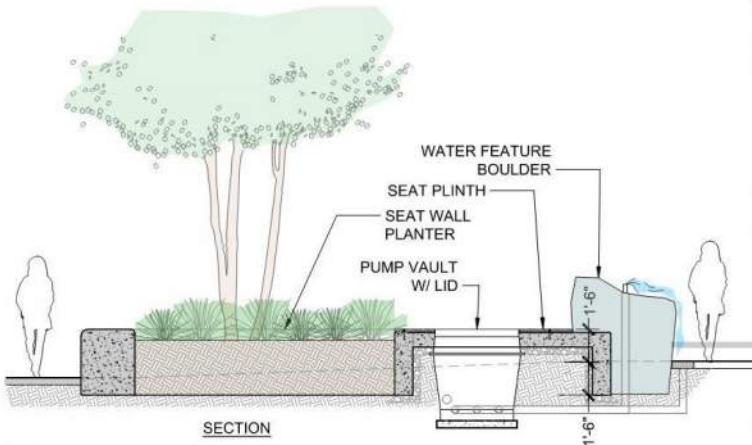

WATER FEATURE



PARKOUR

GOALS:

- All ages and skill levels Parkour equipment
- Community Engagement (decorative fence)
- Simple material palette (Concrete, Steel, Composite Wood)
- Feature Lighting

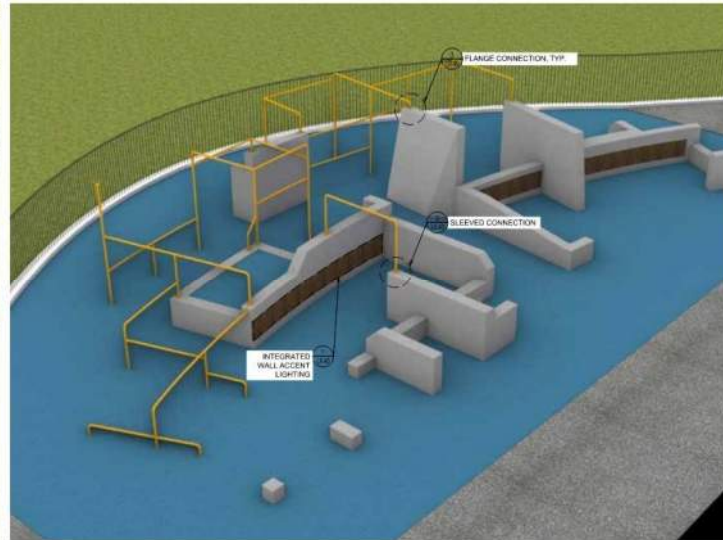
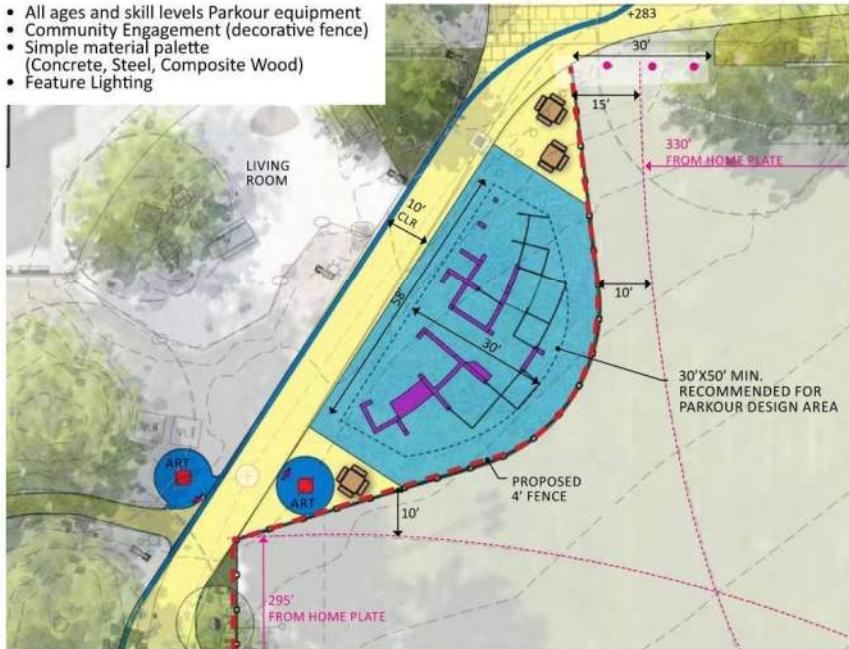

GARFIELD SUPER BLOCK PARK IMPROVEMENTS



SOUTHEAST RAMP & SLIDE

RAMP WALLS: RAMP PATHWAY



RAMP WALLS: BOTTOM OF RAMP



RAMP WALLS: SEATING & GAME VIEWING





COMFORT STATION

- 3 Gender Neutral Restrooms
- Community Concessions
- Maintenance and Storage



The Legacy and Promise Promenade : Pillars of Promise

PUBLIC ART

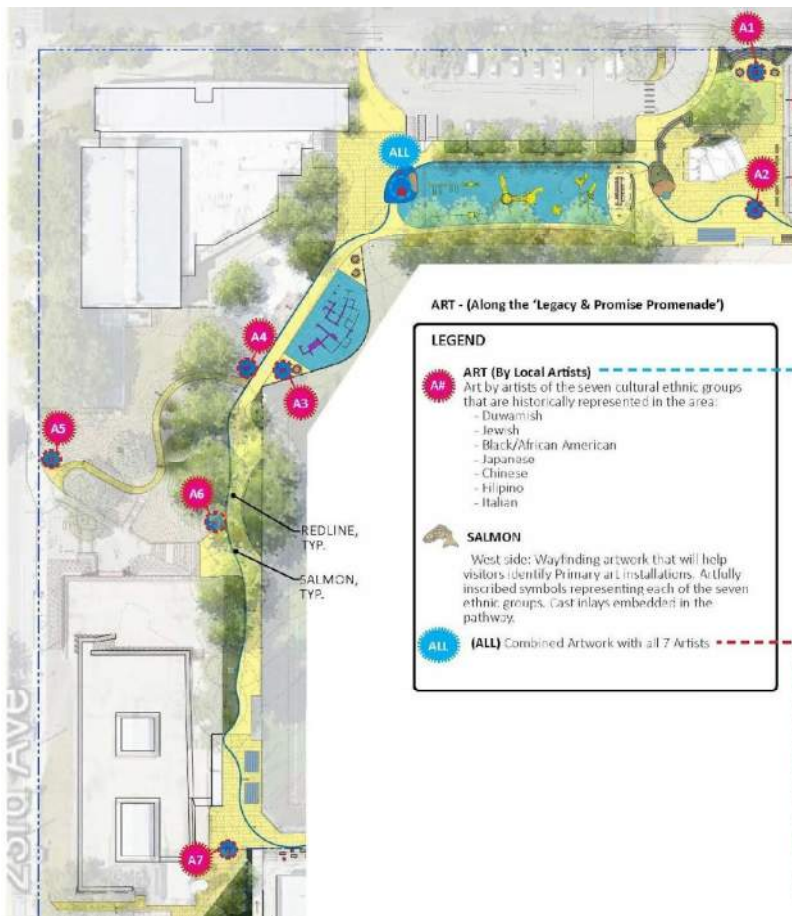

INDIVIDUAL ART

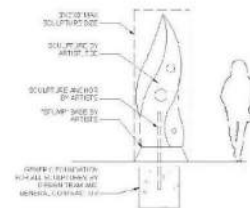
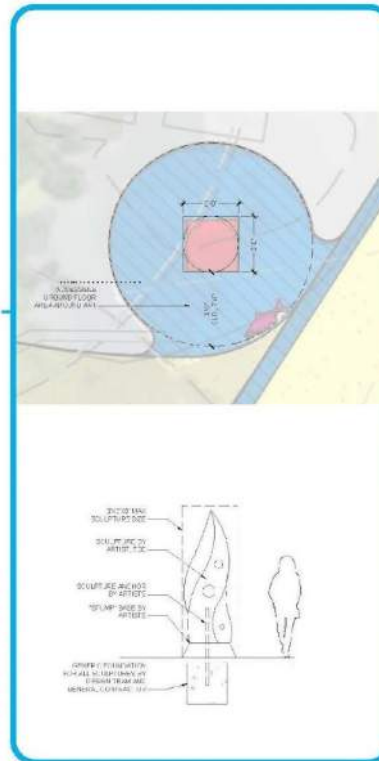

GROUP ART

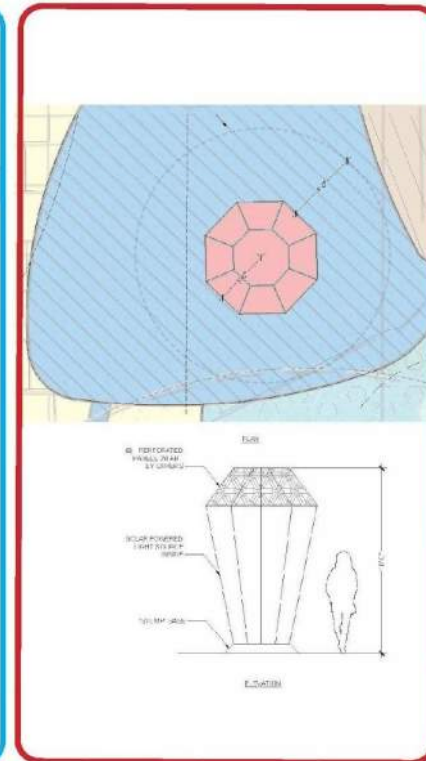



Secondary Art Components



- “Reforesting the Central Area”
- Bronze Salmon Inlays
- Artful Fencing in certain locations
- Youth Led 2-D Artwork on the Comfort Station
- Information and Wayfinding Signage



The Arts Team

PUBLIC ART



ELISHEBA JOHNSON
What Is Public Art?

Elisheba Johnson, co-founder of WaNaWari, a center for Black culture and art in Seattle's Central District, is a conceptual artist with a BFA from Cornish College of the Arts. She was the owner of Faire Gallery Café and worked as a public art project manager at the Seattle Office of Arts & Culture for 7 years, focusing on capacity building initiatives. In 2018, Johnson started a public art practice with her collaborator Kristen Ramirez, creating opportunities that bring equity, accessibility, relevance, and engagement to communities. Elisheba is currently a member of the Americans for the Arts Emerging Leaders Network Advisory Council and has won four Americans for the Arts Public Art Year in Review Awards for her work.



ESTHER ERVIN
Arts Curator

I am an interdisciplinary visual artist raised in Somerville, New Jersey. I have a BS in Biology from UC Irvine, CA and an MFA in Fine Art/ Illustration from CSU Long Beach, CA.

As a Peace Corps volunteer in Colombia, I taught art, science and Spanish at a farm school, and later worked with families of coffee growers. Inspired by drawing for the Peace Corps Health Handbook and for a Bogota cardiologist, I decided to seriously study art.

I explore new techniques and take specialized workshops and enjoy working in various mediums, focusing on environment, politics or abstract works. My jewelry has been exhibited in Washington, Oregon, Beijing, China; Vilnius and Palanga, Lithuania and in Legnica and Gdansk, Poland. While consistently generating and exhibiting mixed-media work and jewelry, I curated over 50 exhibitions, served on local and out-of-state selection panels and had five solo exhibitions. I participate in several arts organizations. My most exciting project to date is working as the art installation curator for the Garfield Super Block.



TAKIYAH WARD
Arts Consultant

Born and raised in Washington, Takiyah Ward, artistically known as T-DUB Customs, is an artist with a style all her own. Her Seattle upbringing played a pivotal role in her creative self-expression — from ballet to tap, basketball to custom sneakers. During her high school years, Takiyah became extremely interested in clothing and sneaker customization. She began hand painting and airbrushing designs on her own clothes and those of her classmates, morphing her hobby into a successful business. Takiyah eventually left Seattle to study architecture at the New York Institute of Technology, where she honed her skills in technical drawing and design.



BREYAHNA COSTON
Arts Consultant

My name is Breyahna "Breeze" Coston. I am from Seattle Washington born and raised. Garfield graduate. One of the lead art consultants on the GSB project. A mixed media artist and muralist. My work is located in Tacoma.



GSB Academy

PUBLIC ART



Free two-day public art workshop for aspiring artists with presenters from all different aspects of public art production.

Artist Selection: Ethnic Advisory Committee

16 Members made up of representatives from the seven ethnic communities that are represented in the Pillars of Promise.



Community Engagement



Community Engagement

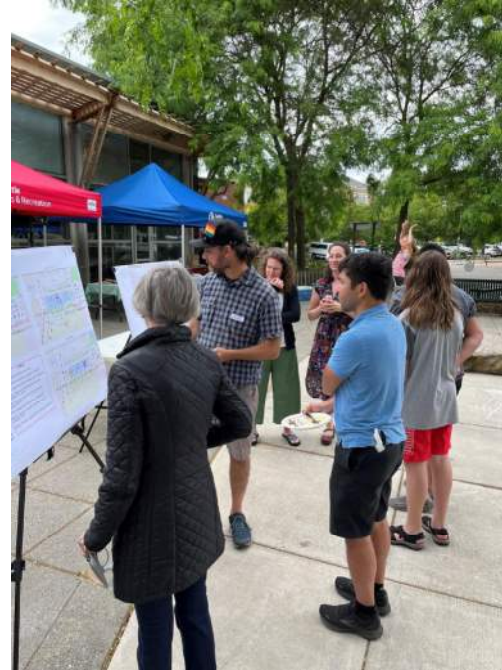

Garfield Super Block Sport Court

The Garfield Super Block Renovation Project wants to know how the community would prefer to use this sport court.

What kind of sport(s) would you like to see included in the Garfield Super Block Sports Court? Please access the survey at the QR code below to share your opinion.

- Tennis
- Basketball
- Pickleball
- Other



SCAN ME

For more information about the Garfield Super Block project, please visit: www.garfieldsuperblock.org



Funding Goals

DESIGN AND CAPACITY

Final Goal
\$900k- \$1M

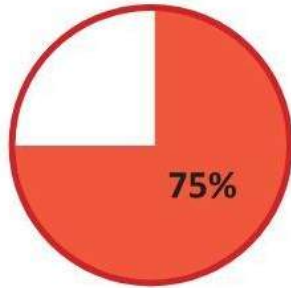

CONSTRUCTION

Final Goal
\$10M

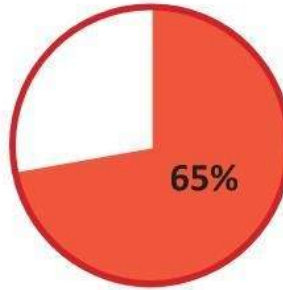

PUBLIC ART CONSTRUCTION AND MANAGEMENT

Final Goal
\$1.5M

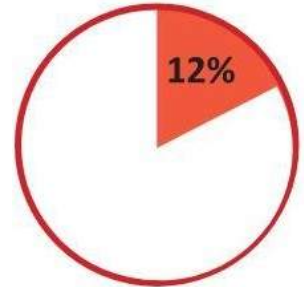

Funding Source:
City of Seattle

Funding Source:
Public Funding via:
City of Seattle
King County
Federal RCO grants

Funding Source:
Private Donors and Foundations

A Group Effort

GSB ORGANIZATION CHART

GSB ETHNIC ADVISORY COMMITTEE

Third Andresen
MalPina Chan
Alex Gallo Brown
Danae Harrison-Corey
Henry Jackson Spieker
Camas Logue
Aleksa Manila
Rainer Metzger
Jake Millett

Hanoko O'Leary
Yvette Perrantes
Harvey Sadis
June Sekiguchi
Steve Sneed
Monica Street
Stewart Wong

GSB STAFF

Arts Team:
Elisheba Johnson
Esther Ervin
Takiyah Ward
Breeze Coston
Alison Post

Support Staff:
Hilary Dameron
Amanda Root
Matt Metzger

GARFIELD SUPER BLOCK CORE COALITION

The Garfield Super Block Coalition is composed of a group of dedicated community volunteers. We are artists, architects, community organizers, labor leaders and veterans.

Robert Stephens Jr.
Esther Ervin
Karen Estevenin
TraeAnna Holiday
Stephanie Ingram
Sharon Khosla
Valentina Montecinos
Ann Suter
Nikki Watanabe

GSB LEAD DESIGNERS

SITE WORKSHOP
Aimee Rozier
Clayton Beaudoin

GSB PARTNERS

Seattle Parks Foundation
City of Seattle; OED, QPCD EDI
Seattle Parks and Recreation
Seattle Public Schools
Parkour Visions
Seattle Neighborhood Greenways
SDOT
Converge Media
Black Heritage Society





Questions?





Donate @ <https://www.garfieldsuperblock.org/donate>

Artists



Michael Halady



Myron Curry



Lauren Iida



Louise Chinn



Huameng Yu



Carina del Rosario



Rainer Adkins



Jessica Bergamino



Monique Worthy



Teruko Nimura



Juliet Shen



Carlmeo Ibanez



Ria Torres



Rachel Kessler



Jaime Colavecchi



Gabreille Abbott